

ORIJENTACIJA STANA U KOMPLEKSU

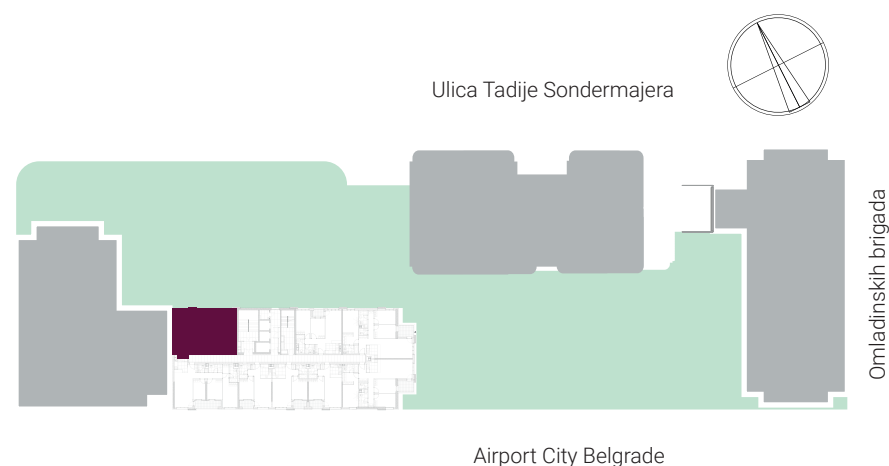

OSNOVA STANA

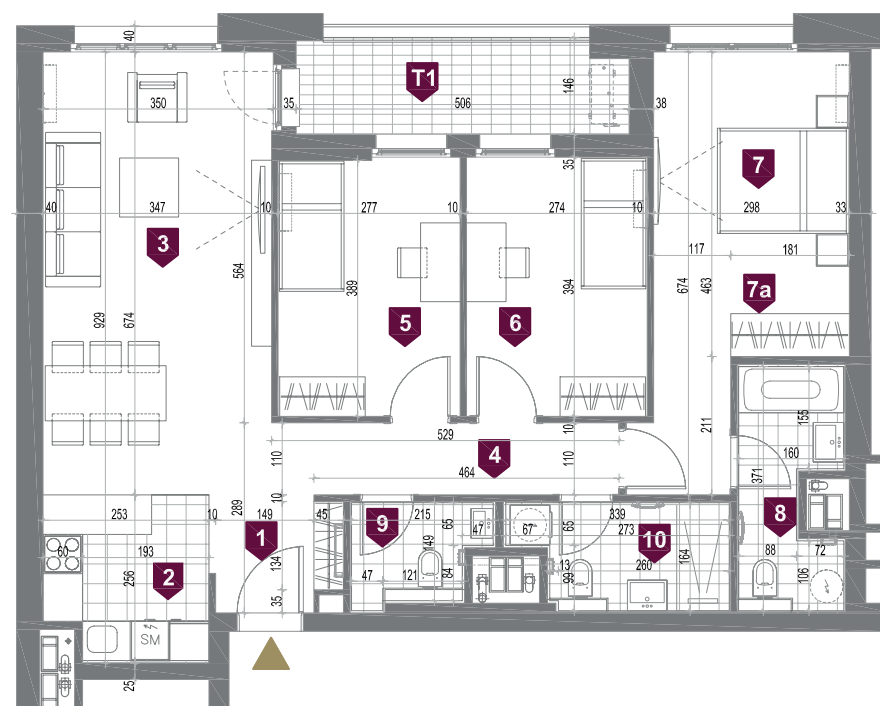

POVRŠINA 078/094/110

| PROSTORIJE | | |
|-----------------------|------------------|----------------------|
| 1 | ULAZNI HODNIK | 3.41 m ² |
| 2 | KUHINJA | 6.07 m ² |
| 3 | DNEVNA SOBA | 24.11 m ² |
| 4 | DEGAŽMAN | 5.08 m ² |
| 5 | SPAVAĆA SOBA | 10.82 m ² |
| 6 | SPAVAĆA SOBA | 10.82 m ² |
| 7 | GL. SPAVAĆA SOBA | 14.34 m ² |
| 7a | GARDEROBA | 2.36 m ² |
| 8 | KUPATILO | 5.30 m ² |
| 9 | TOALET | 5.01 m ² |
| 10 | KUPATILO | 2.85 m ² |
| NETO STANA BEZ TERASE | | 90.17 m ² |
| T1 | TERASA | 7.23 m ² |
| UKUPNO | | 97.40 m ² |

POVRŠINA 086/102

| PROSTORIJE | | |
|-----------------------|------------------|----------------------|
| 1 | ULAZNI HODNIK | 3.41 m ² |
| 2 | KUHINJA | 6.07 m ² |
| 3 | DNEVNA SOBA | 24.11 m ² |
| 4 | DEGAŽMAN | 5.08 m ² |
| 5 | SPAVAĆA SOBA | 10.82 m ² |
| 6 | SPAVAĆA SOBA | 10.82 m ² |
| 7 | GL. SPAVAĆA SOBA | 14.34 m ² |
| 7a | GARDEROBA | 2.36 m ² |
| 8 | KUPATILO | 5.30 m ² |
| 9 | TOALET | 5.01 m ² |
| 10 | KUPATILO | 2.85 m ² |
| NETO STANA BEZ TERASE | | 90.17 m ² |
| T1 | TERASA | 7.87 m ² |
| UKUPNO | | 98.05 m ² |

3D PRIKAZ STANA



7 078

8 086

9 094

10 102

11 110

4